

# Standard Pacific Park

## General Team 3

**Client Consultant:** Bryan Redsun P.E., RRM Design Group

**Project Manager:** Ziran Liu, ziranl2@uci.edu

**Team Members:** Richard Ceja, Ruisi Xian, Violeta Castillo, Zhifeng Wu

**Winter Design Review 2020**



### Project Description

A park will be designed to meet the demands of the community in the City of Encinitas. The park design will include a dog park, playground, basketball court, restroom, picnic area, and an amphitheater. There will be a storm water quality management plan in order to meet the codes and requirements of the City of Encinitas, and also County of San Diego. The water and sewage will be managed in the park. Grading is required in this area because of the vast differences in the elevation. The estimated cost of construction will be monitored.

### Design Approach

The major direction is the community outreach results; the desire of the community and the surrounding facilities situation.

We are following the guideline of the City of Encinitas Municipal Code and the American Disability Act to make the park to be Disabled-Friendly. The paramount is safety, convenience, environment, and community interactivity. .

### Design Constraints & Parameters

Design and Facilities location should consider the effect toward nearby residence and each other. (e.g. dual dog parks and distance from playground to dog parks)

The erosion control and air quality effect control should be done by Qualified SWPPP Developer and follow relevant codes.

In the design, we utilize the existing grade information provided by USGS to decide the layout.

### Standard Pacific Park Layout



### Standard Pacific Park Layout

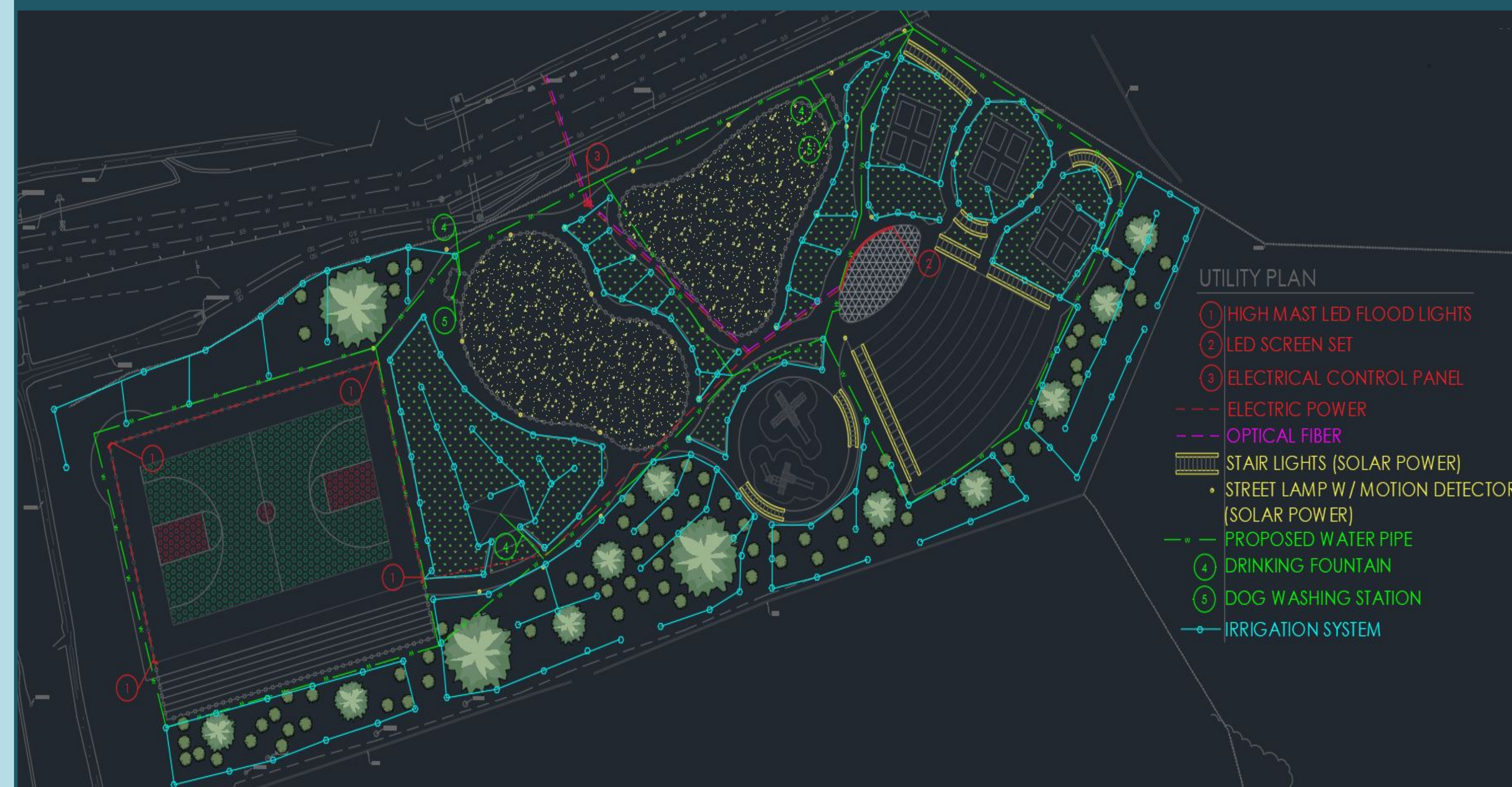

### Alternative Designs



### Cost Estimation

Facilities	\$206,380
Dry Utilities	\$32,000
Wet Utilities	\$10,000
Permit	\$1,925
Labor	\$82,552
Contingency	\$20,638
<b>Total Cost</b>	<b>\$353,495</b>

### Next Phase

Bid-Ready Construction  
Storm Water Quality Management Plan  
Sewer and Water study